

## Extrusion

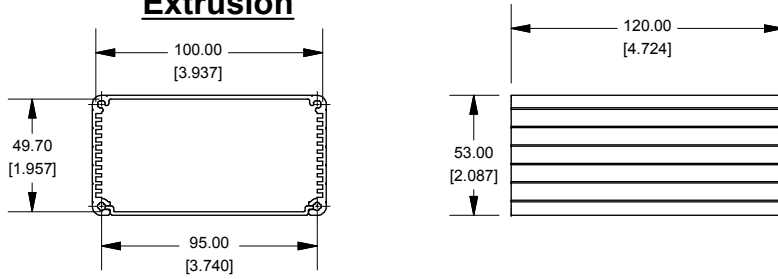

EXTRUSIONS DESIGNED FOR 100MM WIDE PC BOARD

## Slot Details

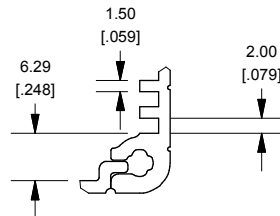

## End Plate

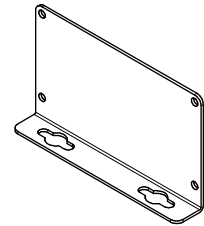
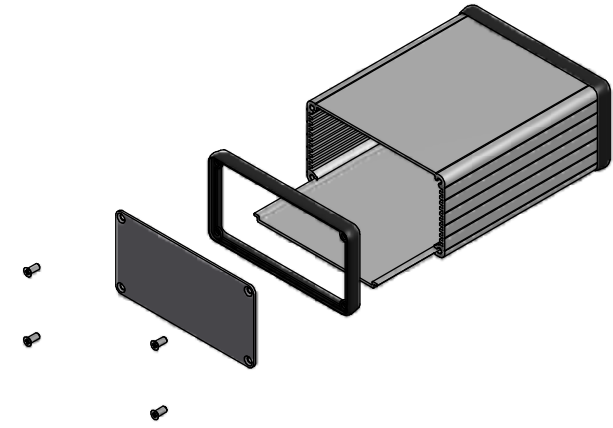
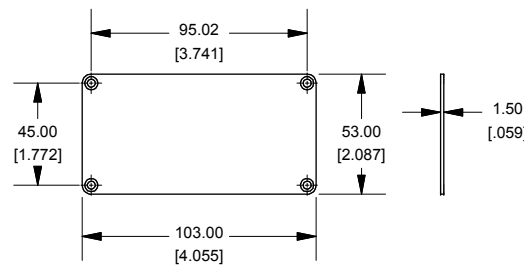

## OPTIONAL FLANGE END PANELS 1455NF

Enclosures can be Factory Modified ( Milling, Drilling, Printing etc. )  
Solid models of this enclosure available in STEP or IGES.  
Contact Factory [mjm@hammondmfg.com](mailto:mjm@hammondmfg.com)

### NOTE

Purchased assembly includes box, plastic bezels, end panels, #6  
Taptight screws and self adhesive rubber feet.  
Box made from Extruded Aluminum 6063.  
Bezels made with polycarbonate.

### 1455N1201

#### PART NUMBERS

Clear Anodized	1455N1201
Black Anodized	1455N1201BK

#### ACCESSORIES

See website for accessories.



## Open Bezel

